

TOTAL MILES	
Township Road System	38.24*
State Highway System	14.86
Total	53.10

* Includes ACT 32 Turnback Mileage of 4.19

LEGEND

- LIMITED ACCESS HIGHWAY
- STATE ROUTE AND NUMBER
- STATE MAINTAINED BRIDGE ON TOWNSHIP ROAD
- TOWNSHIP ROAD, NUMBER AND SEGMENT LENGTH IN MILES
- IMPASSABLE TOWNSHIP ROAD
- OTHER ROAD
- RAILROAD (IN SERVICE)
- RAILROAD ABANDONED (TRACK RETAINED)
- STATE BOUNDARY
- COUNTY BOUNDARY
- TOWNSHIP BOUNDARY
- CITY OR BOROUGH BOUNDARY
- MUNICIPAL BUILDING
- SPLIT MILEAGE BETWEEN MUNICIPALITIES

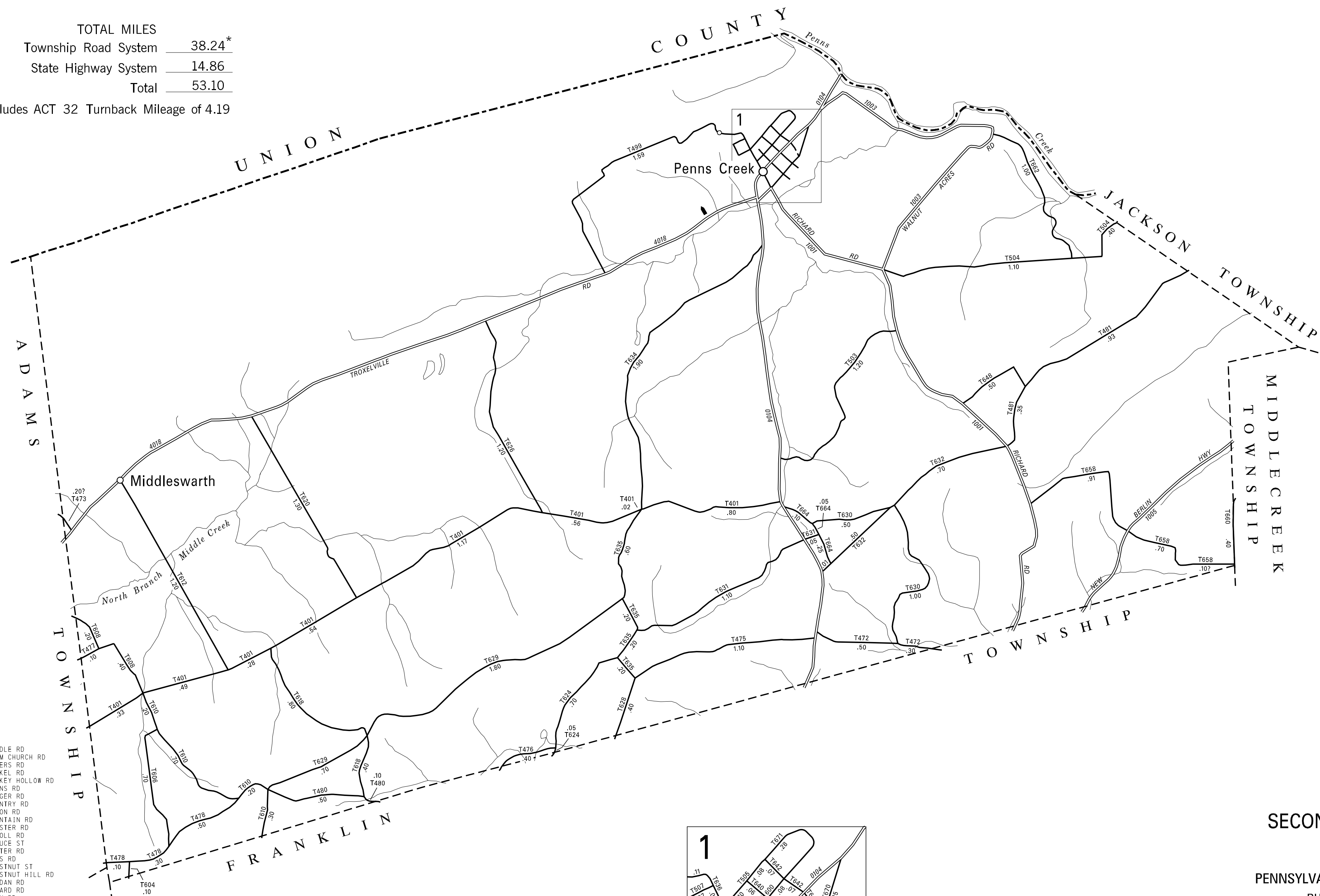

- 401 MIDDLE RD
- 472 SALM CHURCH RD
- 473 MOYERS RD
- 475 BICKEL RD
- 476 TURKEY HOLLOW RD
- 477 KUHN'S RD
- 478 LONGER RD
- 480 COUNTRY RD
- 481 BREDON RD
- 499 MOUNTAIN RD
- 503 KEISTER RD
- 504 SCHOLL RD
- 505 SPRUCE ST
- 506 WALTER RD
- 507 LOSS RD
- 600 CHESTNUT ST
- 604 CHESTNUT HILL RD
- 606 JORDAN RD
- 608 RENARD RD
- 610 ZION RD
- 612 HARTMAN RD
- 618 BERGEE RD
- 620 ZERBE RD
- 624 SPRUCE HOLLOW RD
- 626 BUCKSEY RD
- 628 DADDARIO HILL RD
- 629 STARLIGHT DR
- 630 TITTLE RD
- 631 FITZER RD
- 632 SHAMBACH RD
- 634 BOWERSOX RD
- 635 HACKENBURG RD
- 636 RASPBERRY ST
- 638 PINE ST
- 640 MULBERRY ST
- 642 PENN ST
- 648 DELONG RD
- 658 SMITH RD
- 660 OAK LA
- 662 KERR RD
- 664 ORCHARD LA
- 670 WALNUT ST
- 671 WALNUT RIDGE RD

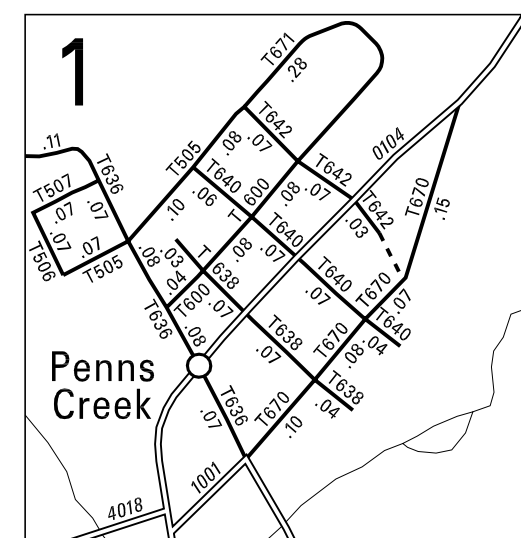

2:1

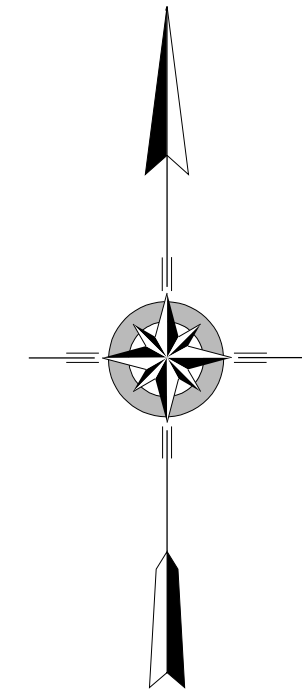

**CENTER
SECOND CLASS TOWNSHIP MAP
SNYDER COUNTY**

PREPARED BY THE
PENNSYLVANIA DEPARTMENT OF TRANSPORTATION
BUREAU OF PLANNING AND RESEARCH
GEOGRAPHIC INFORMATION DIVISION
IN COOPERATION WITH THE
U.S. DEPARTMENT OF TRANSPORTATION
FEDERAL HIGHWAY ADMINISTRATION
MUNICIPAL CODE 54 203

REVISED PER FORM 990 DATED 11-19-04

